

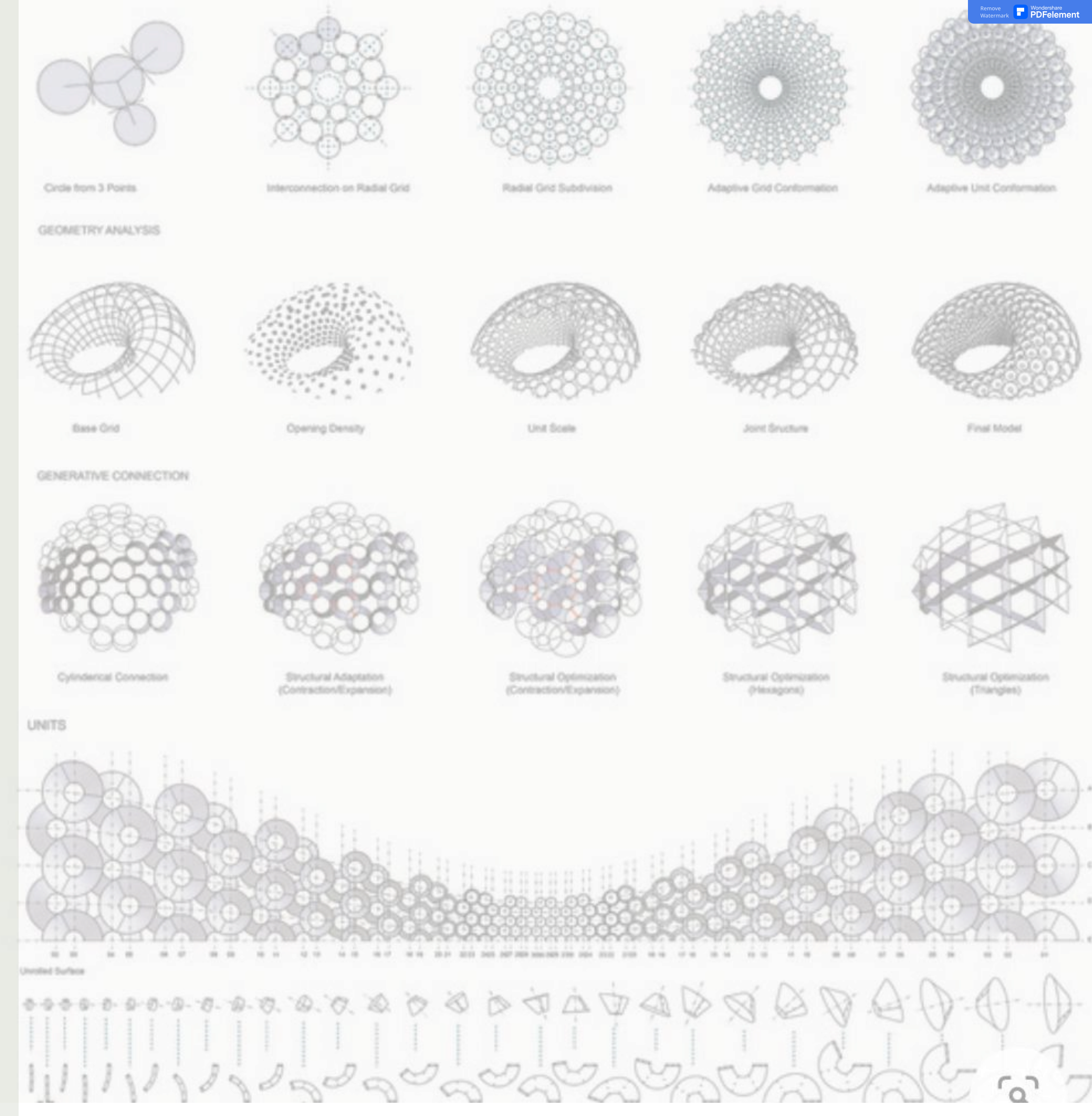

Resonance Project Concept







Cambodia, is a country on the Indochinese mainland of Southeast Asia. Cambodia is largely a land of plains and great rivers and lies amid important overland and river trade routes linking [China](#) to [India](#) and Southeast Asia. The influences of many Asian cultures, alongside those of [France](#) and the United States, can be seen in the capital, Phnom Penh, one of a handful of urban centres in the largely rural country.

Kampot is a province in southwestern Cambodia. It borders the provinces of Koh Kong and Kampong Speu to the north, Takéo to the east, Kep and the country of Vietnam to the south, and Sihanoukville to the west. To its south it has a coastline of around 45 km on the Gulf of Thailand. It is rich in low arable lands and has abundant natural resources. Its capital is the city of Kampot.

Kampot Province had a population of 627,884 in 2010 and consist of eight districts divided into 92 communes with a total of 477 villages. Touk Meas City is located in the province.

#### History

In the 19th century, during the French Indochina period, Kampot became a regional administrative center with the status of a state border district as a result of the delimitation of the Kingdom of Cambodia. The Circonscription Résidentielle de Kampot contained the arrondissements of Kampot, Kompong-Som, Trang and Kong-Pisey.

In 1889, French colonial census reports a multi-ethnic community: Kampot town consisted of "Cambodian Kampot" on the Prek-Kampot River and "Chinese Kampot" on the right riverbank of the west branch of the Prek-Thom River. Nearby was also a Vietnamese village, called Tien-Thanh and another Vietnamese village on Traeuy Koh Island. A Malay also existed on Traeuy Koh Island. There are additional villages of mixed ethnicity.

location



Imagine an awe-inspiring sight: an architectural marvel that seamlessly blends art and mathematics, celebrating the principles of pure beauty and acoustic perfection. The exterior of this extraordinary auditorium draws upon the form of a huge nautilus shell, a testament to the wonders of organic design. Every curve and contour crafted to adhere to the principles of the golden mean, a widely known harmonious mathematical ratio used by numerous artists such as Leonardo da Vinci. Here we see the ancient architectural world revitalised in an ultra-modern context.

This world-class amphitheatre will captivate all who behold it. It is proposed for the township known as Kompot in Southern Cambodia. Nestled beside a flowing river that leads to the gulf of Thailand and set against a tropical mountainous backdrop, it will be a spectacular architectural icon reflecting the cultural heritage that is distinctive of this wonderful country.

As you approach the auditorium, you are greeted by an intricate fusion of natural elements and human ingenuity. The outer shell, formed in a textural ancient earthy style showcases a mesmerizing array of organic spiralling patterns that draws your gaze inward. Reminiscent of ancient Hindu and Buddhist temple design, the textures reflect the ambient sunlight, casting a warm glow that illuminates the surroundings with grace and sensitivity.

The entrance to the auditorium is a portal to a world of artistic splendour and intellectual enlightenment. The doors, adorned with intricate carvings inspired by nature and cultural art, invite you to step into a space where creativity and knowledge converge. The fusion of materials, from the sculptured roots and vines of the Banyan tree to the gleaming metal

fixtures and reliefs, highlight the symbiotic relationship between the organic and the man-made.

This is a time machine in a sense where the viewer is compelled to contemplate the past and consider the potential of the future. The interior of the auditorium is equally captivating, a transition in

time where a contrast is made manifest by the juxtaposition of advanced technology and futuristic design, a testament to the careful orchestration of acoustics and aesthetics. The seating arrangement follows the gentle curvature of the nautilus shell, ensuring that every individual has an optimal view and an immersive experience. The walls, adorned with flowing patterns inspired by the natural world, yet ultra-modern, create a sense of serenity and harmony. The ceiling, a breathtaking display of intricate patterns reminiscent of fractals, draws your gaze upward, evoking a sense of wonder and connection to the infinite.

The stage, positioned at the heart of the auditorium, is a focal point of creative expression. Its design pays homage to the golden mean, with symmetrical elements that echo the organic flow of nature. From this vantage point, performers are immersed in an environment that inspires their artistic pursuits fostering a deep connection with the audience. Acoustically, the design is congruent with producing perfect sound in harmony with the anatomy of the human ear. The cochlea of the ear drum is similar in design to the golden ratio, so it follows that this structure is compatible with exquisite audio projection frequencies. This landmark structure will invariably attract the greatest accomplished musicians both locally and from around the world.

The combination of architectural mastery and the golden mean ratio creates a space that is both visually striking and acoustically sublime. The auditorium stands as a testament to the limitless possibilities when art and mathematics intertwine, demonstrating the power of organic design to inspire and uplift the human spirit.

Iconic, spectacular, ancient and yet, futuristic. These are just some of the unique qualities of the Kronicity project.

As you stand before this auditorium, you are reminded of the intricate beauty that exists in nature's patterns and the boundless creativity of the human mind. It is a place where art, science, and nature converge, inviting you to immerse yourself in the transformative power of harmonious design.

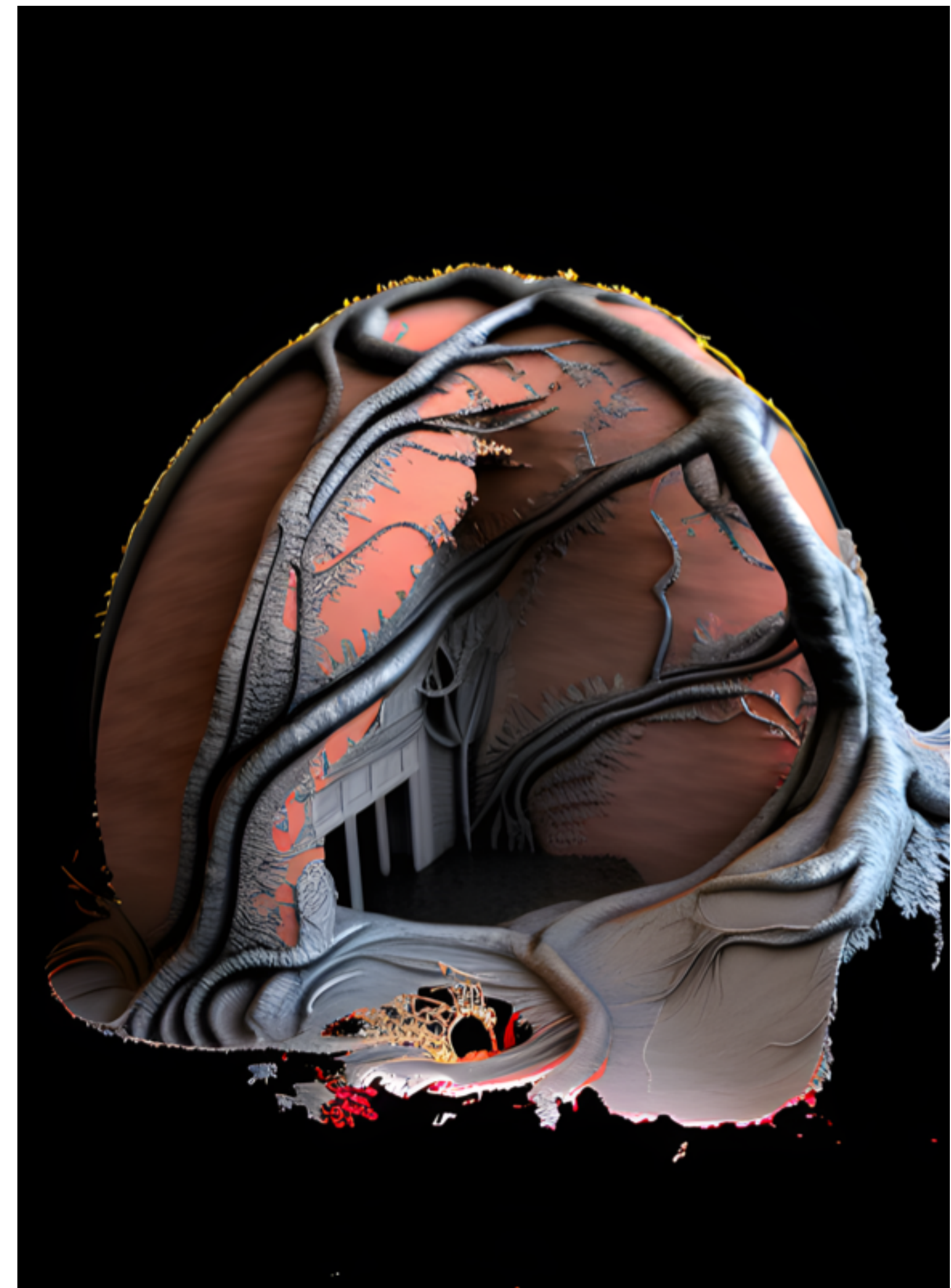

project intention



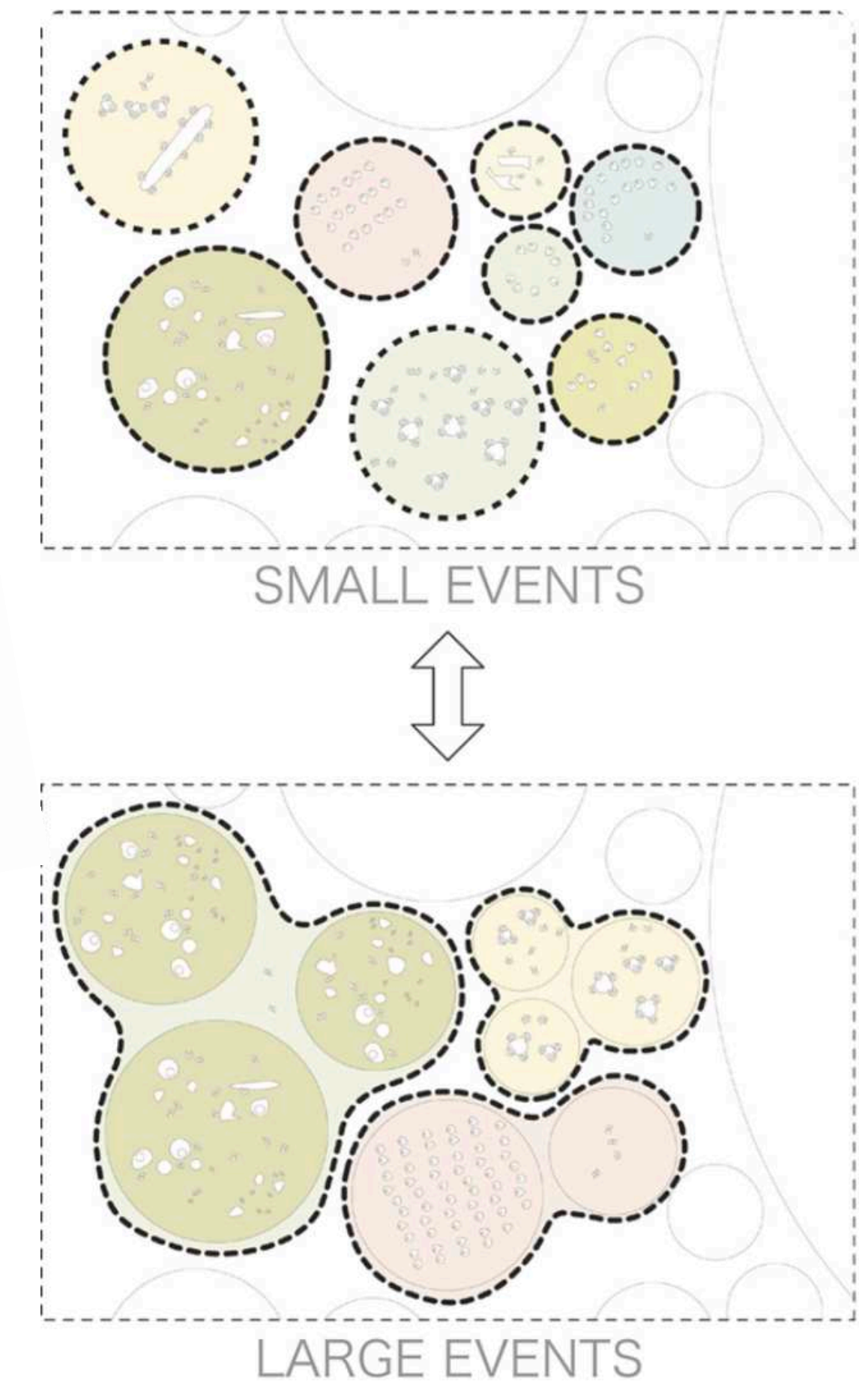
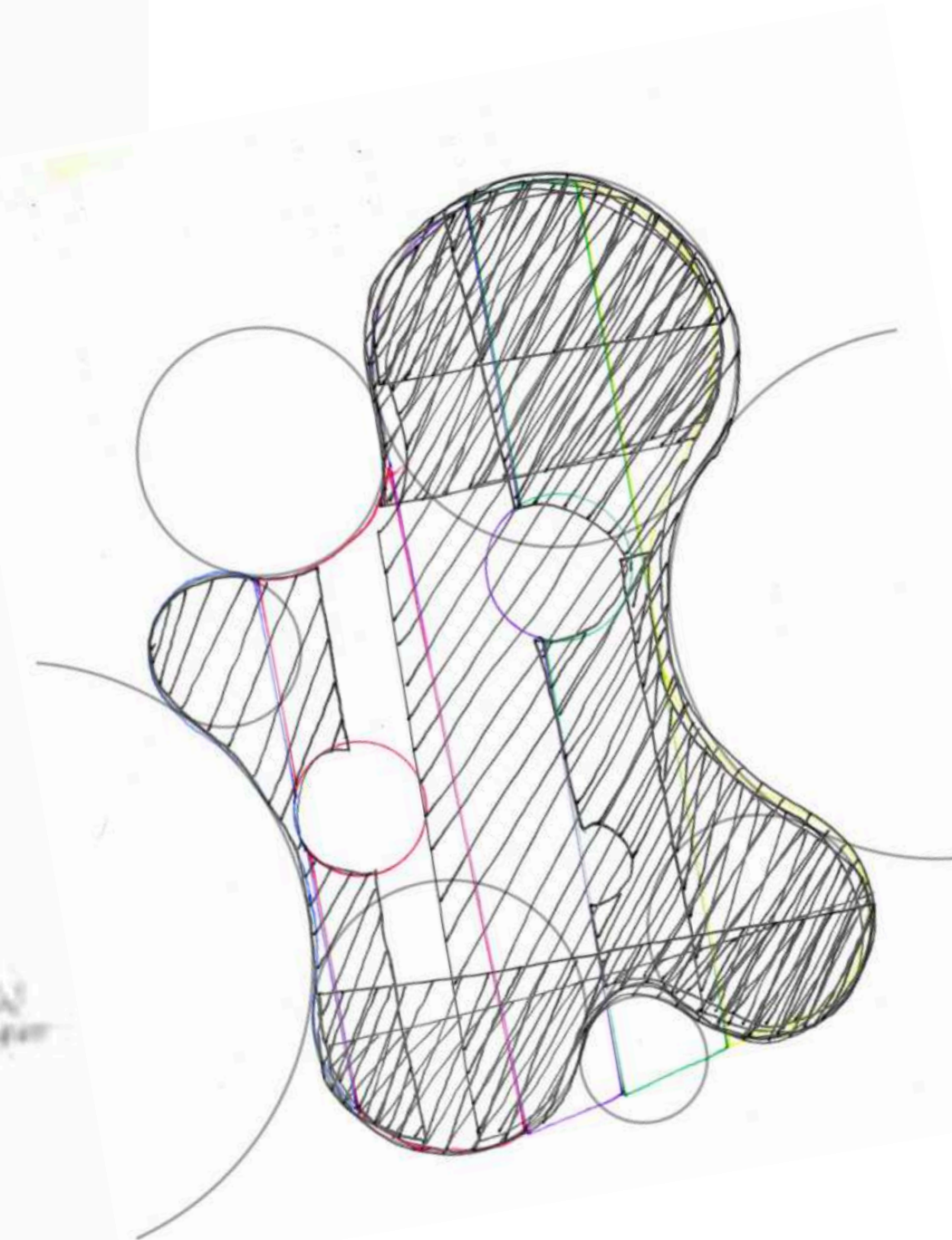
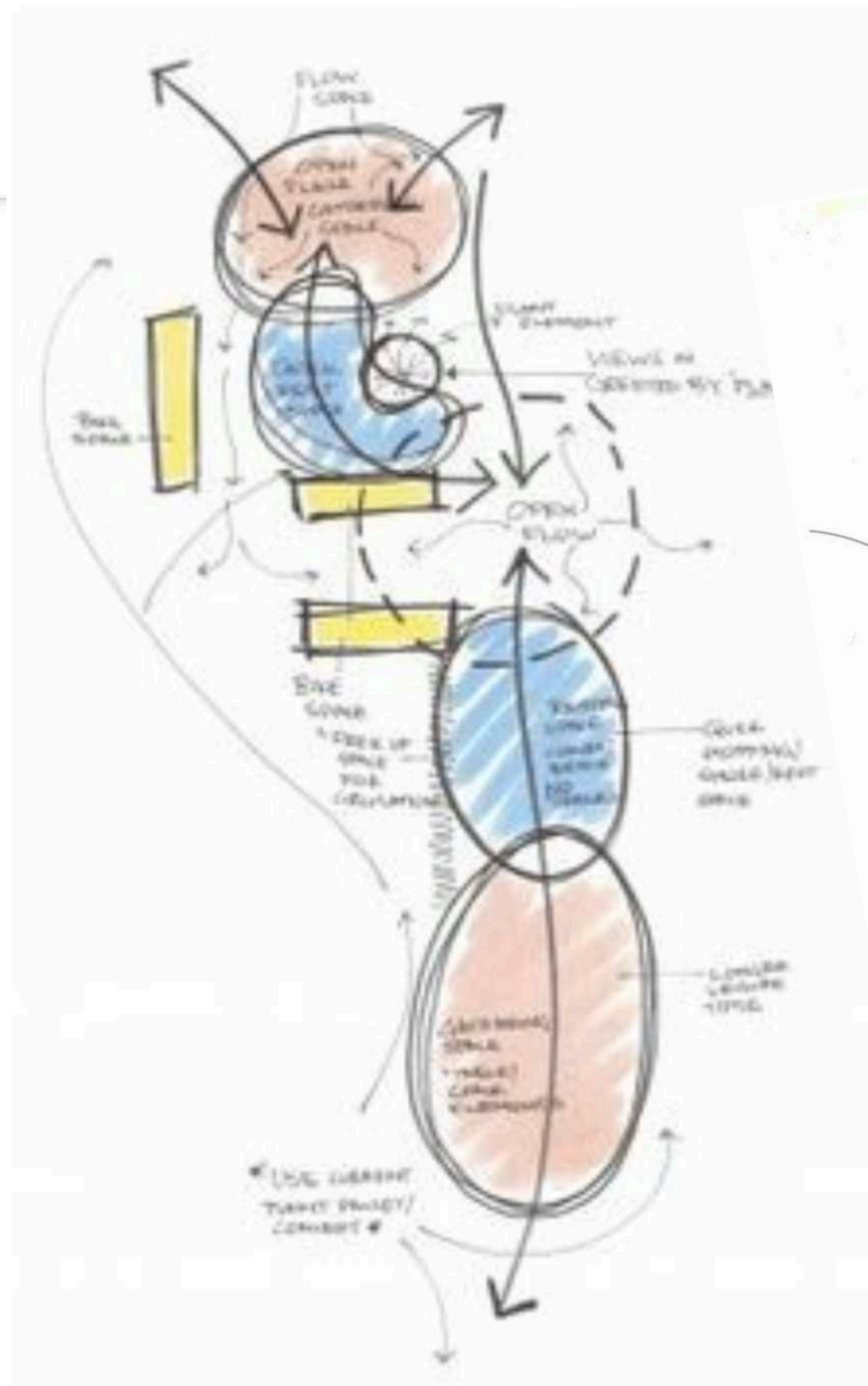

spacial planning



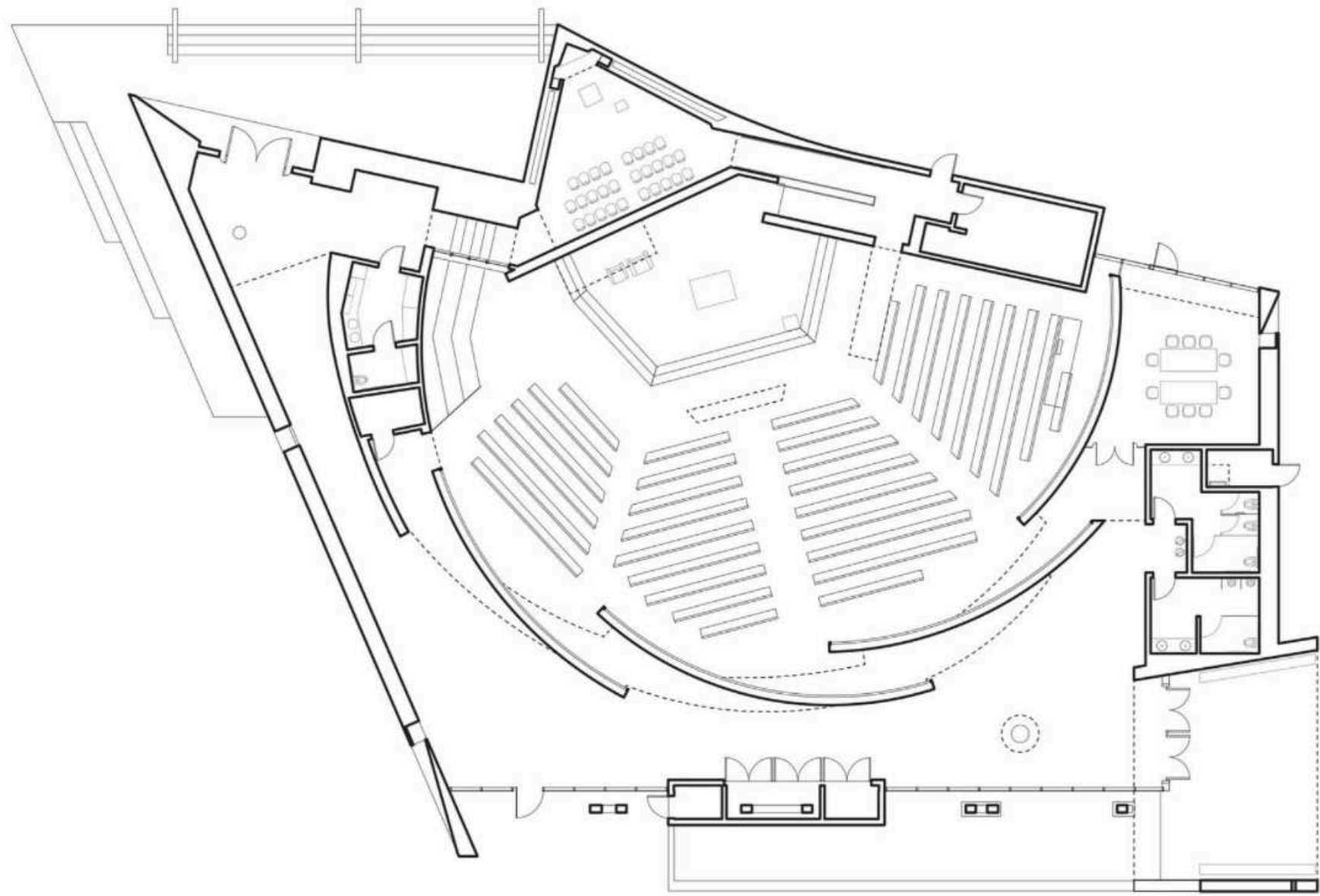

0 2m 5m 10m

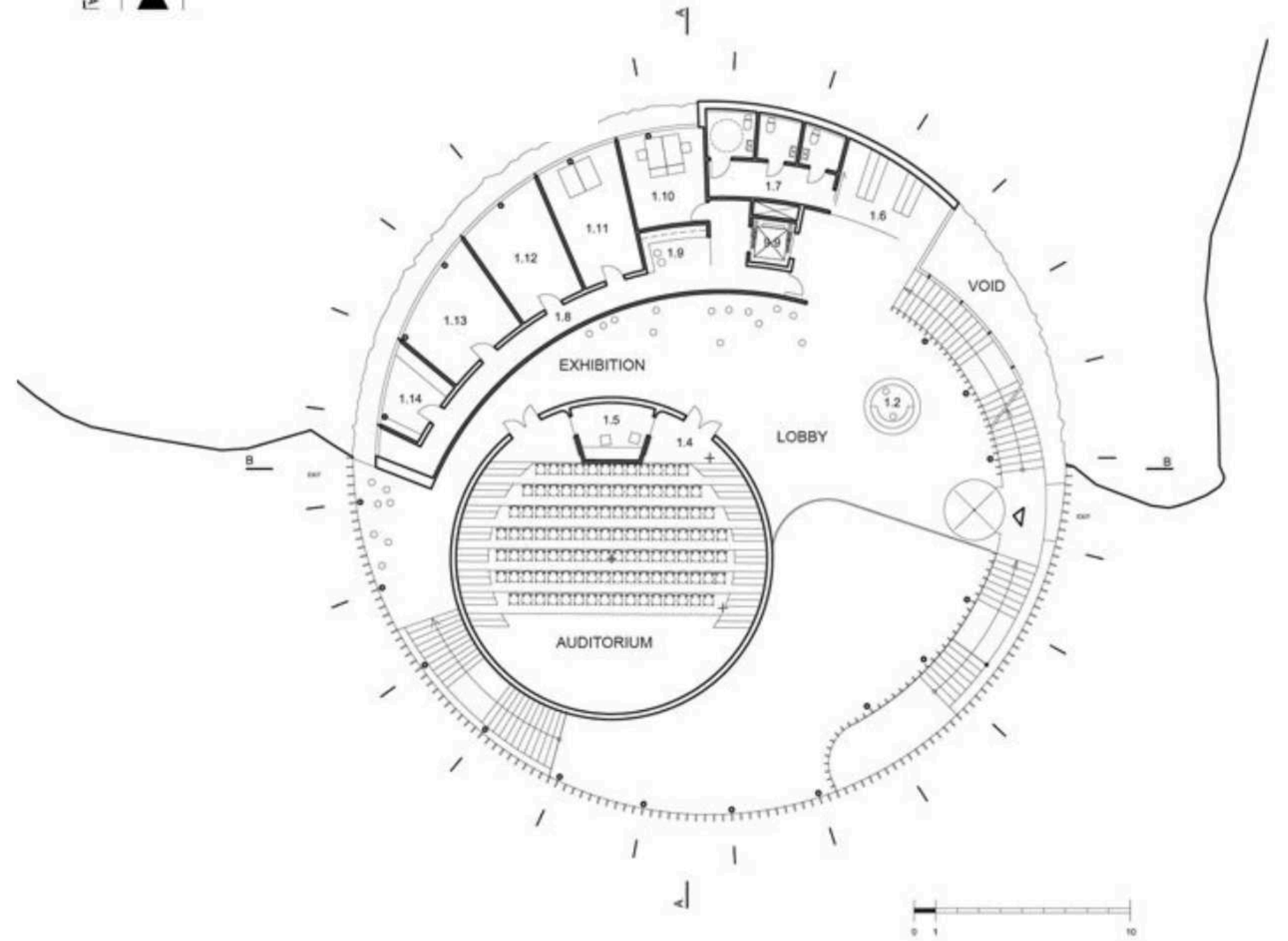
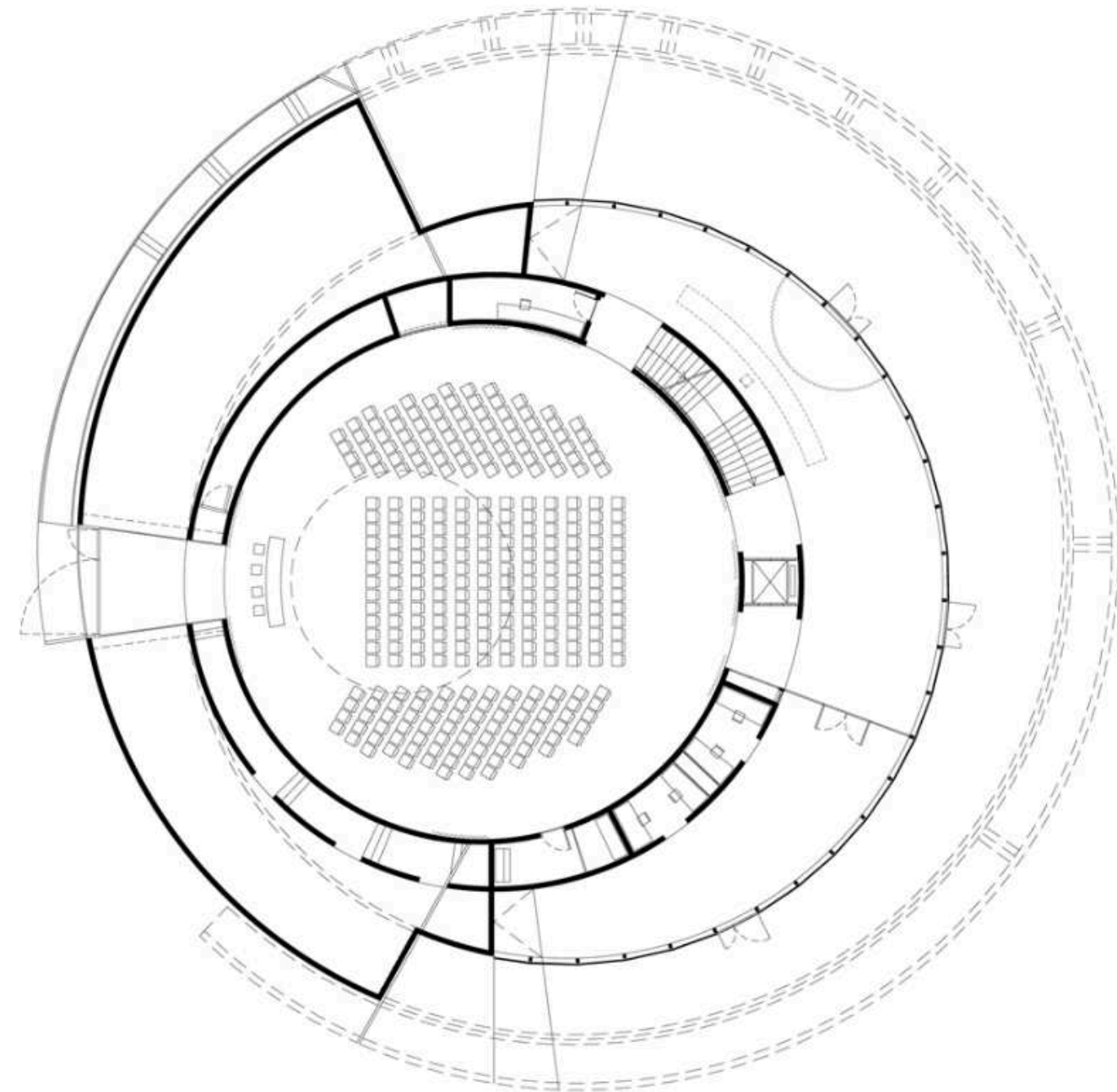
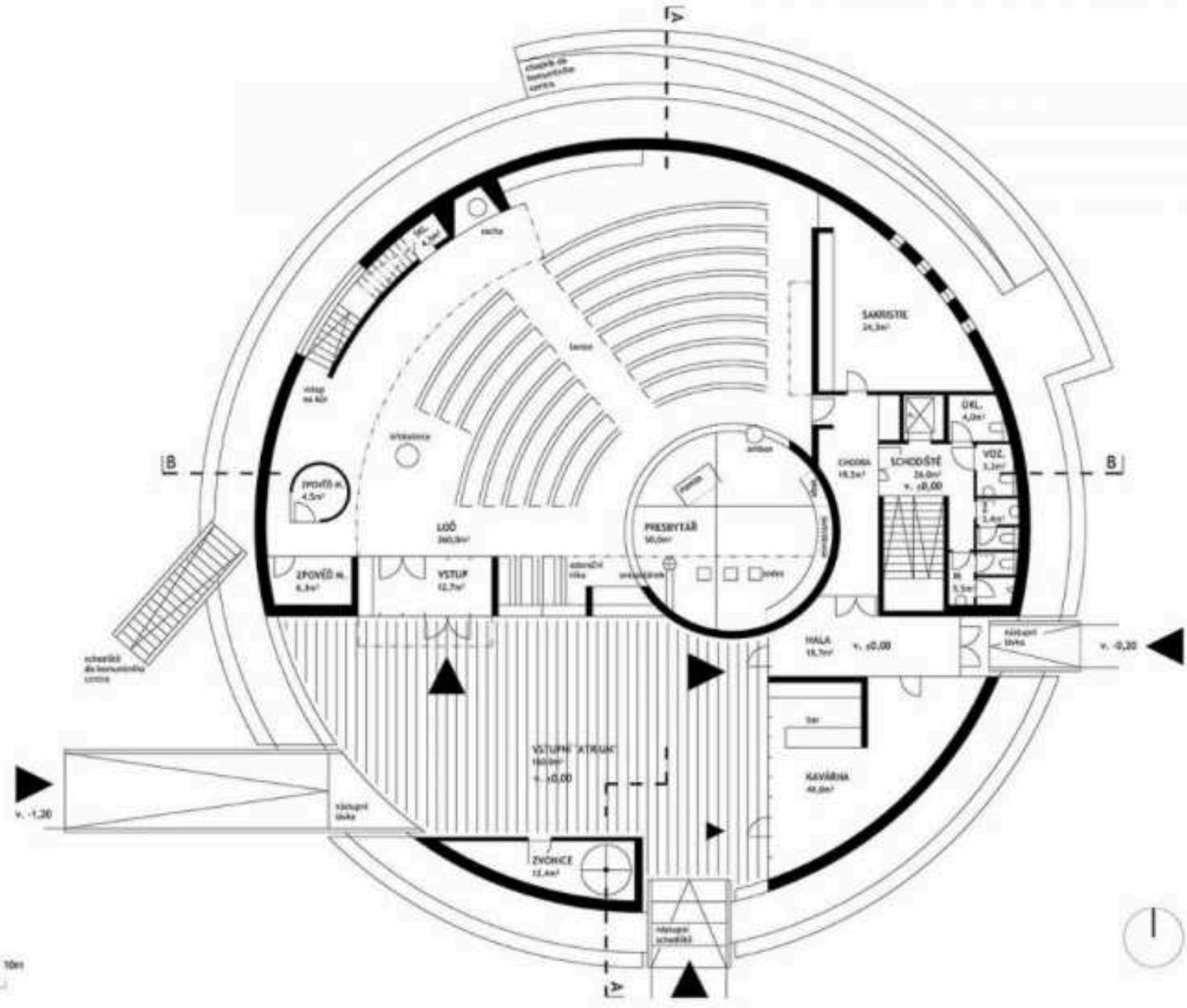

Some indication of the facilities you will need to provide. They can be integrated into the main auditorium or provided in seperate structures.

layouts



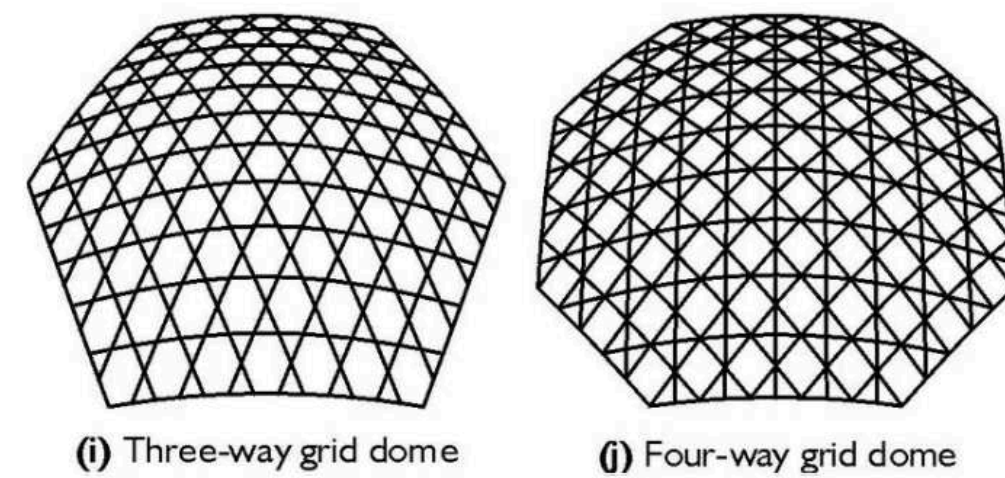
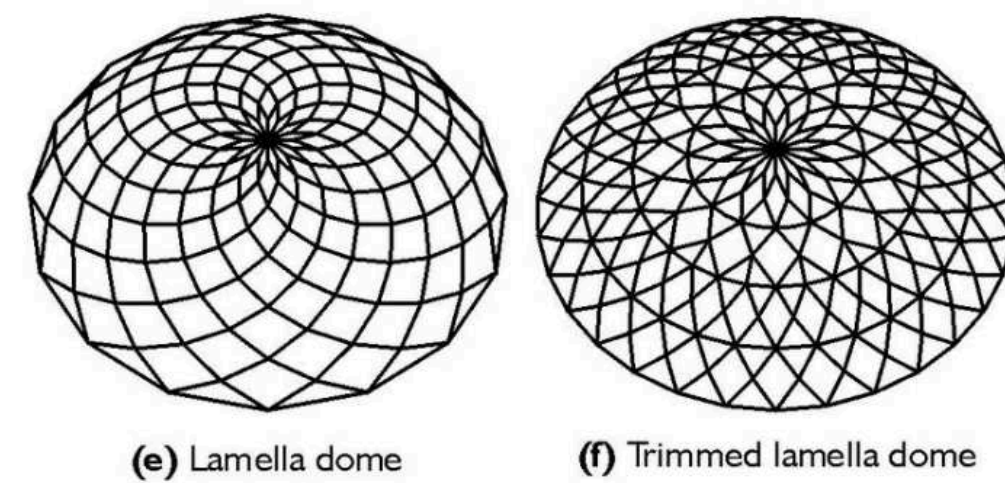
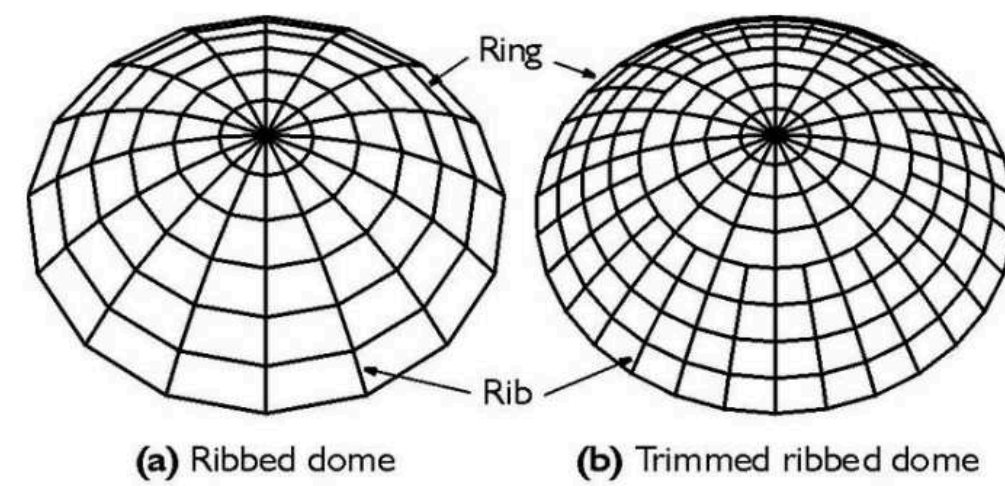
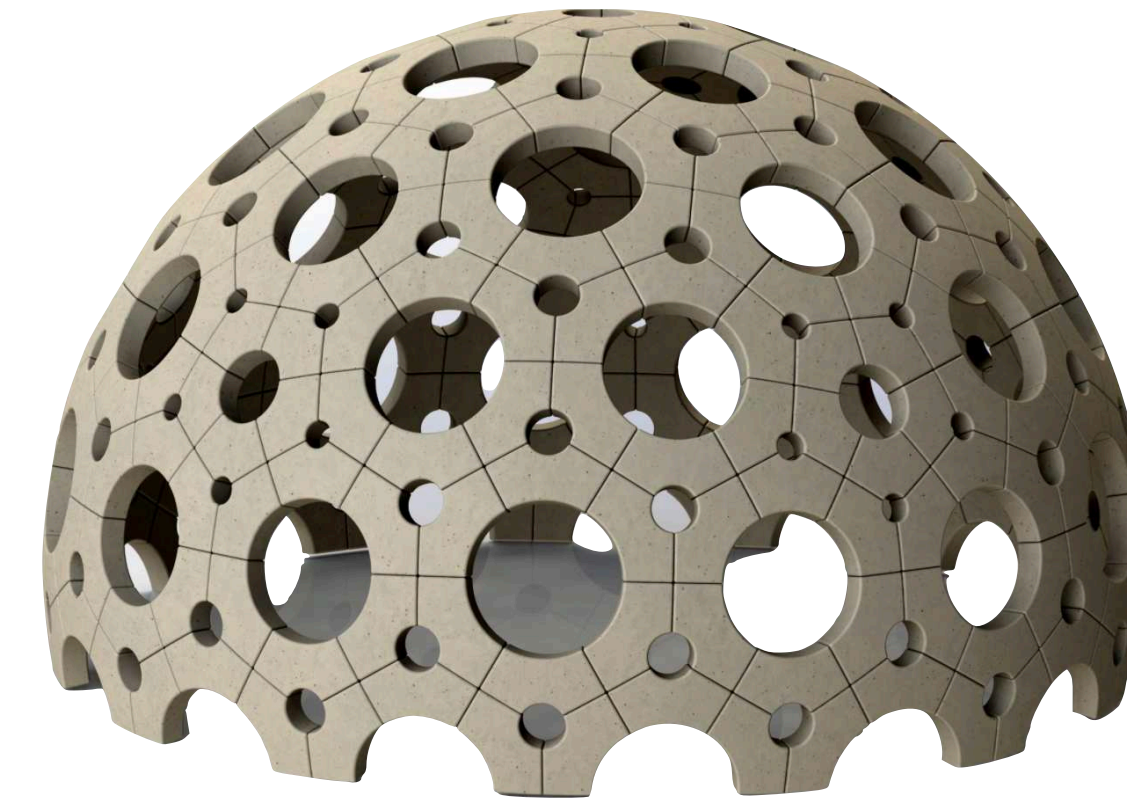
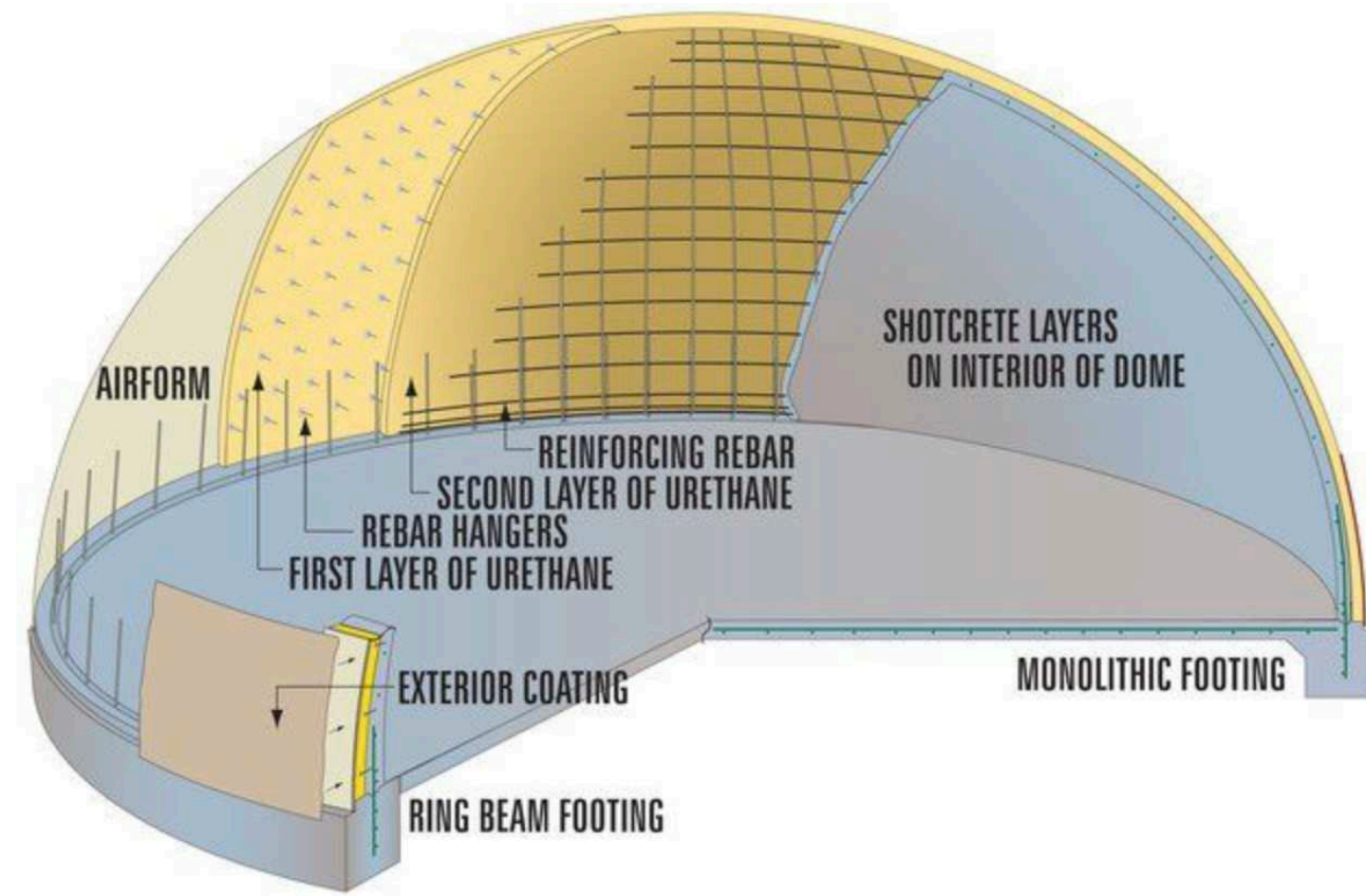

construction methods  
that are self supporting

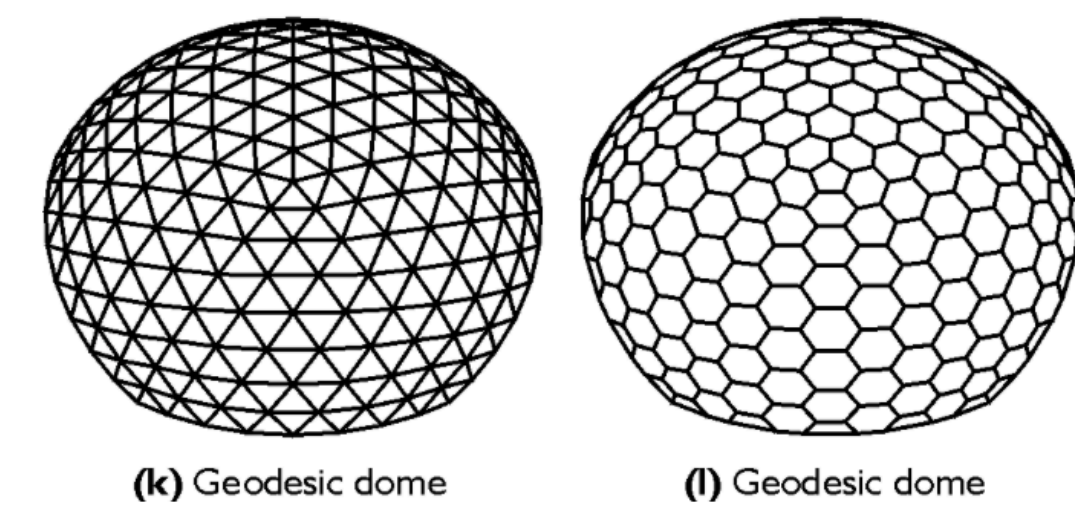
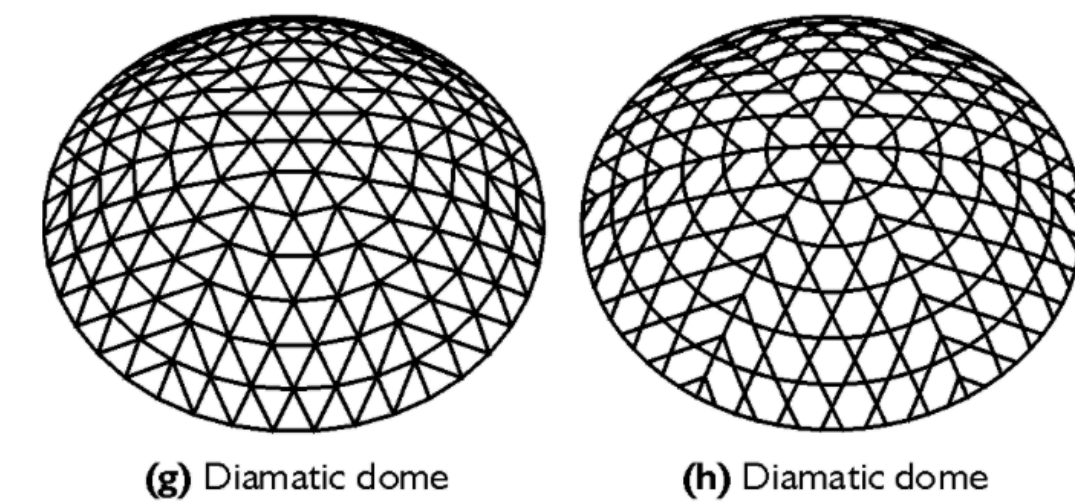
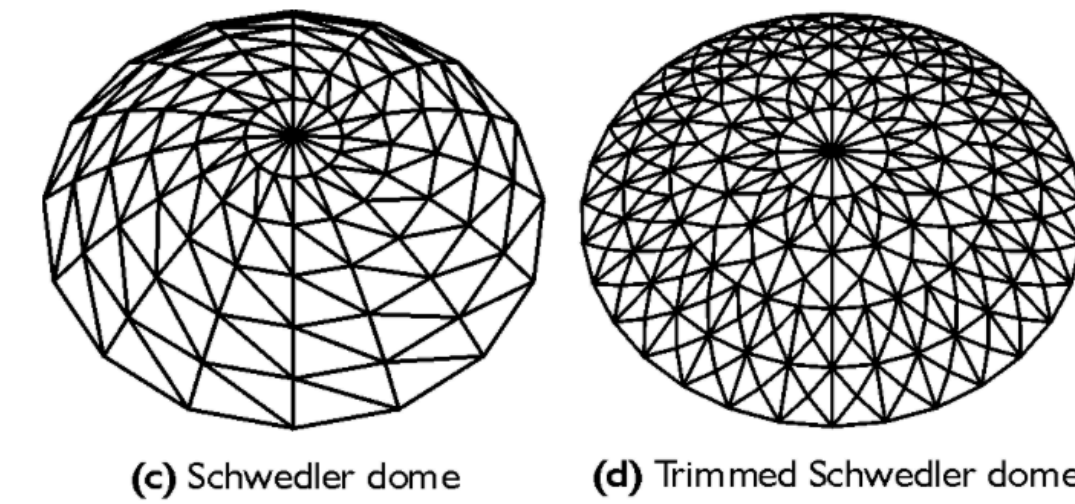



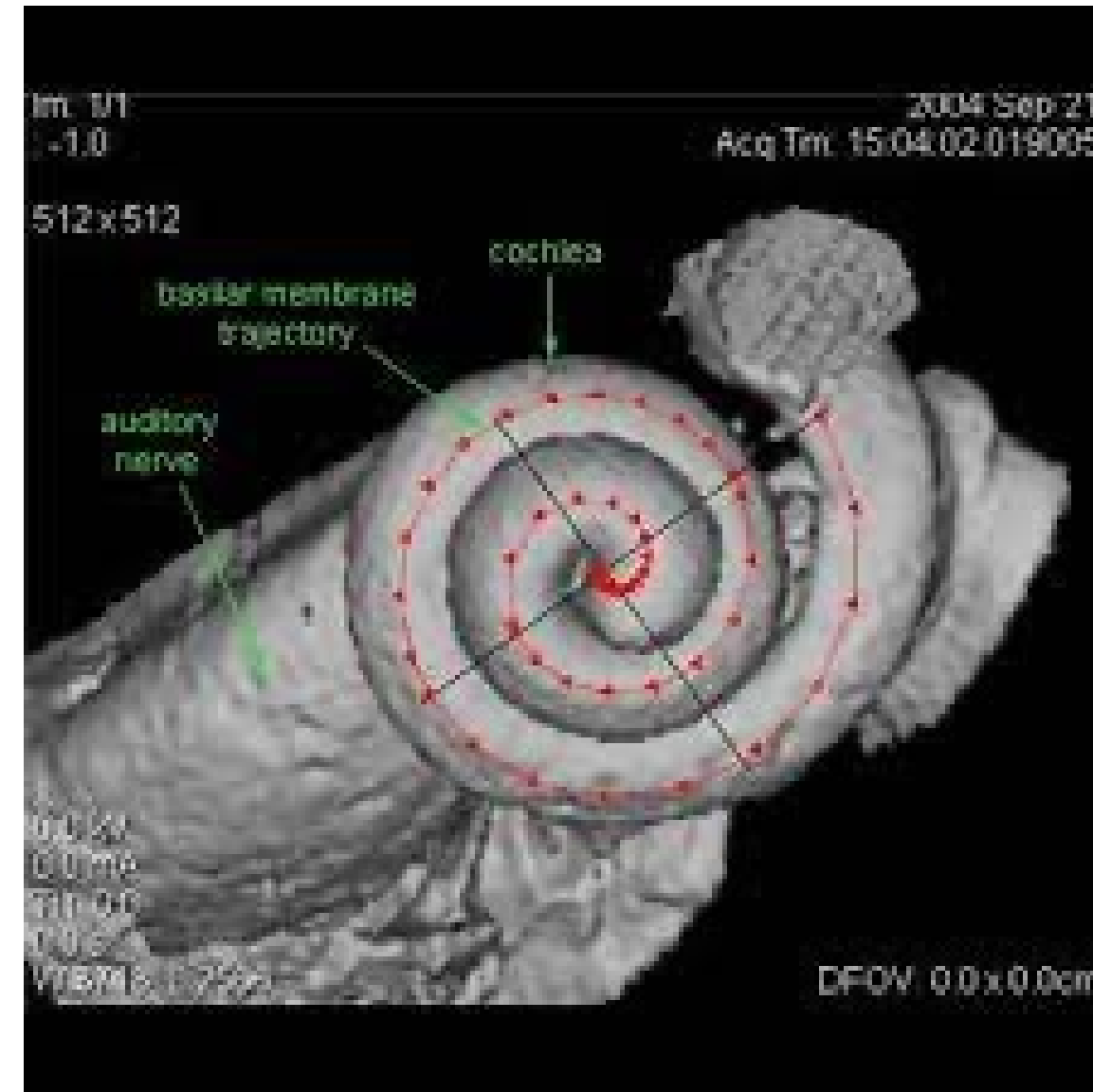

A large, ancient tree with massive, exposed roots growing over and around a small, partially ruined stone structure, possibly a temple or shrine, in a forest setting. The roots are thick and gnarled, cascading down the front of the building and spreading across the ground in front of it. The stone structure has a small, dark doorway and some remnants of white plaster or paint. The background shows a dense forest with tall, thin trees under a blue sky with some clouds.





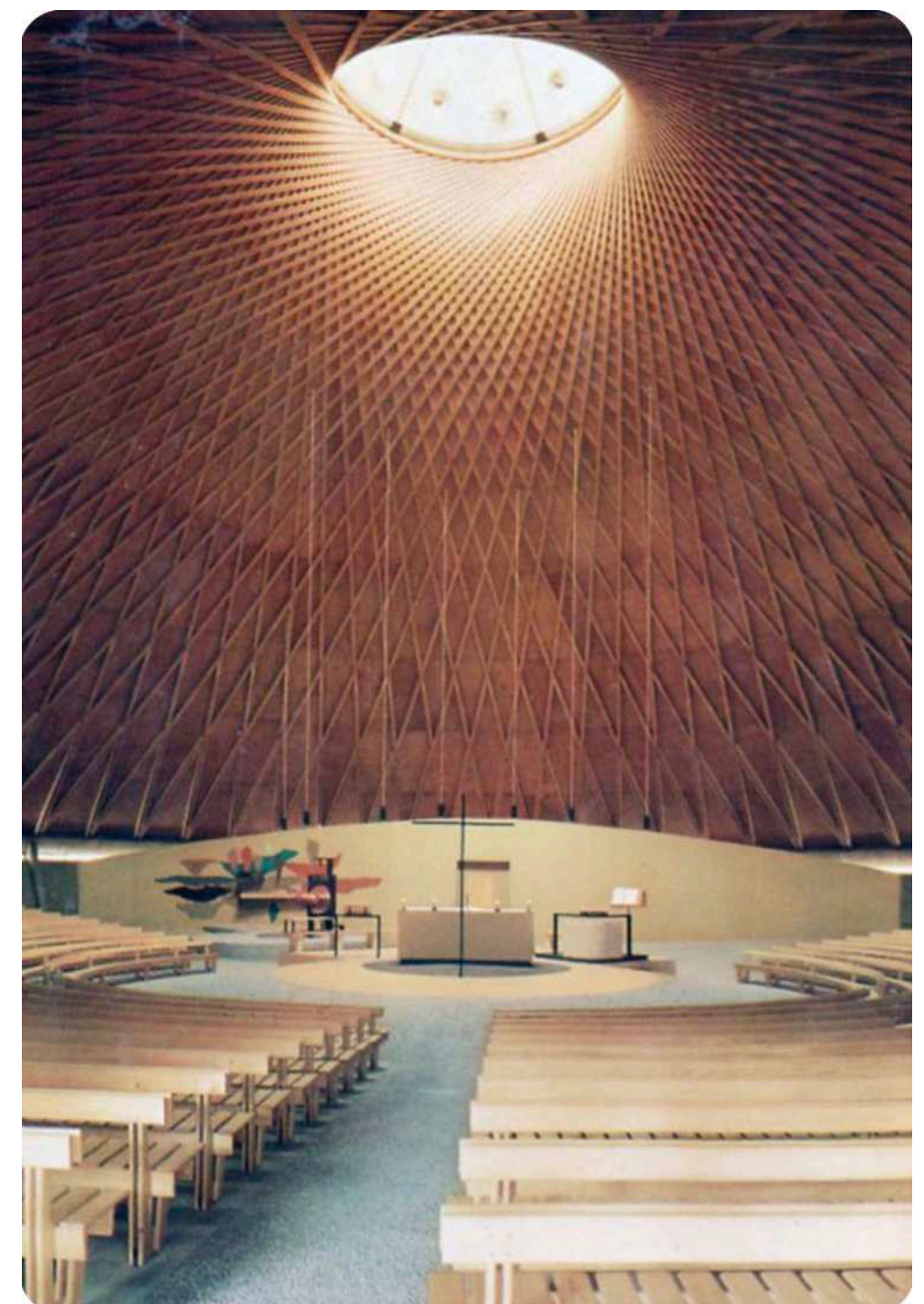
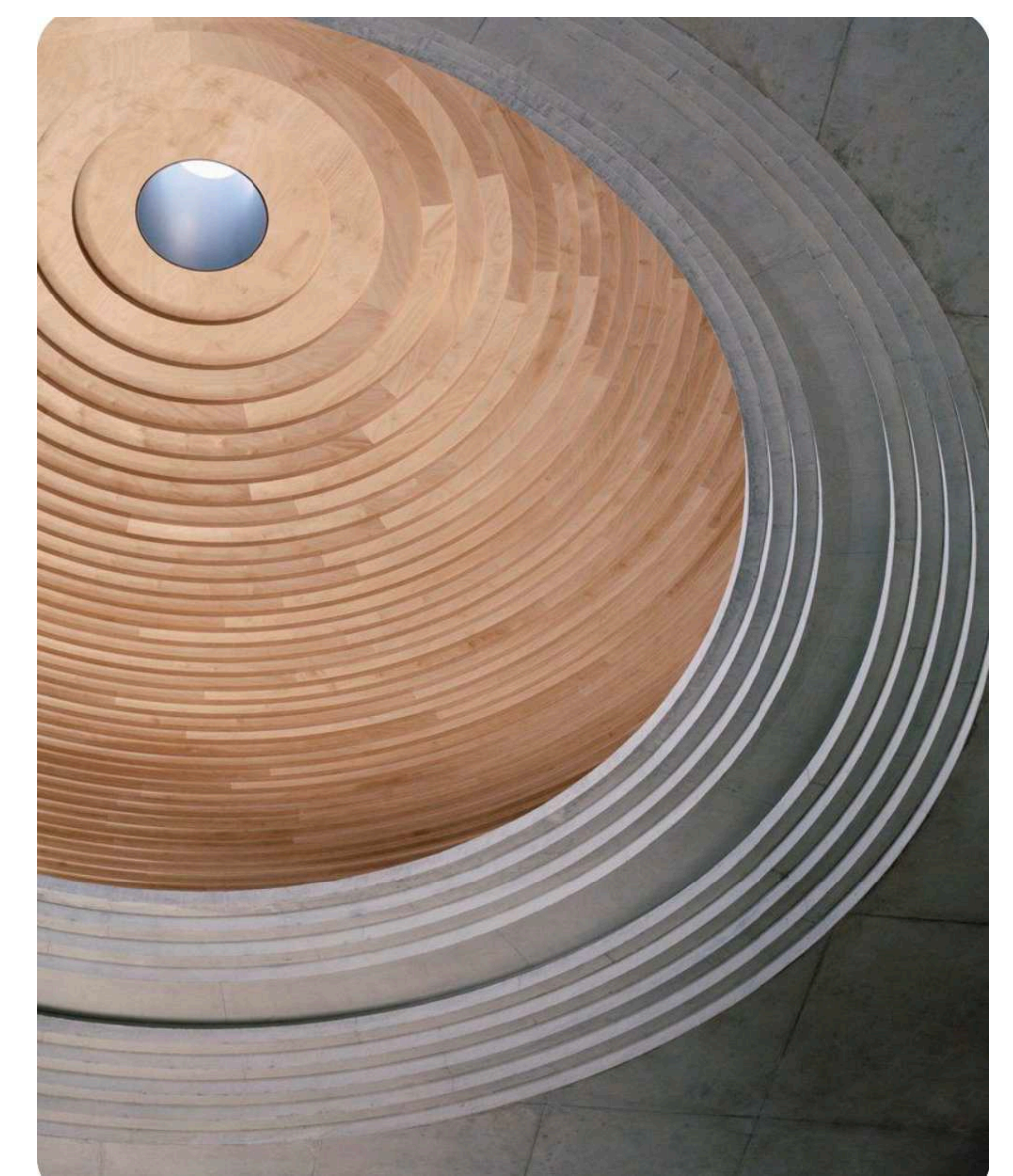
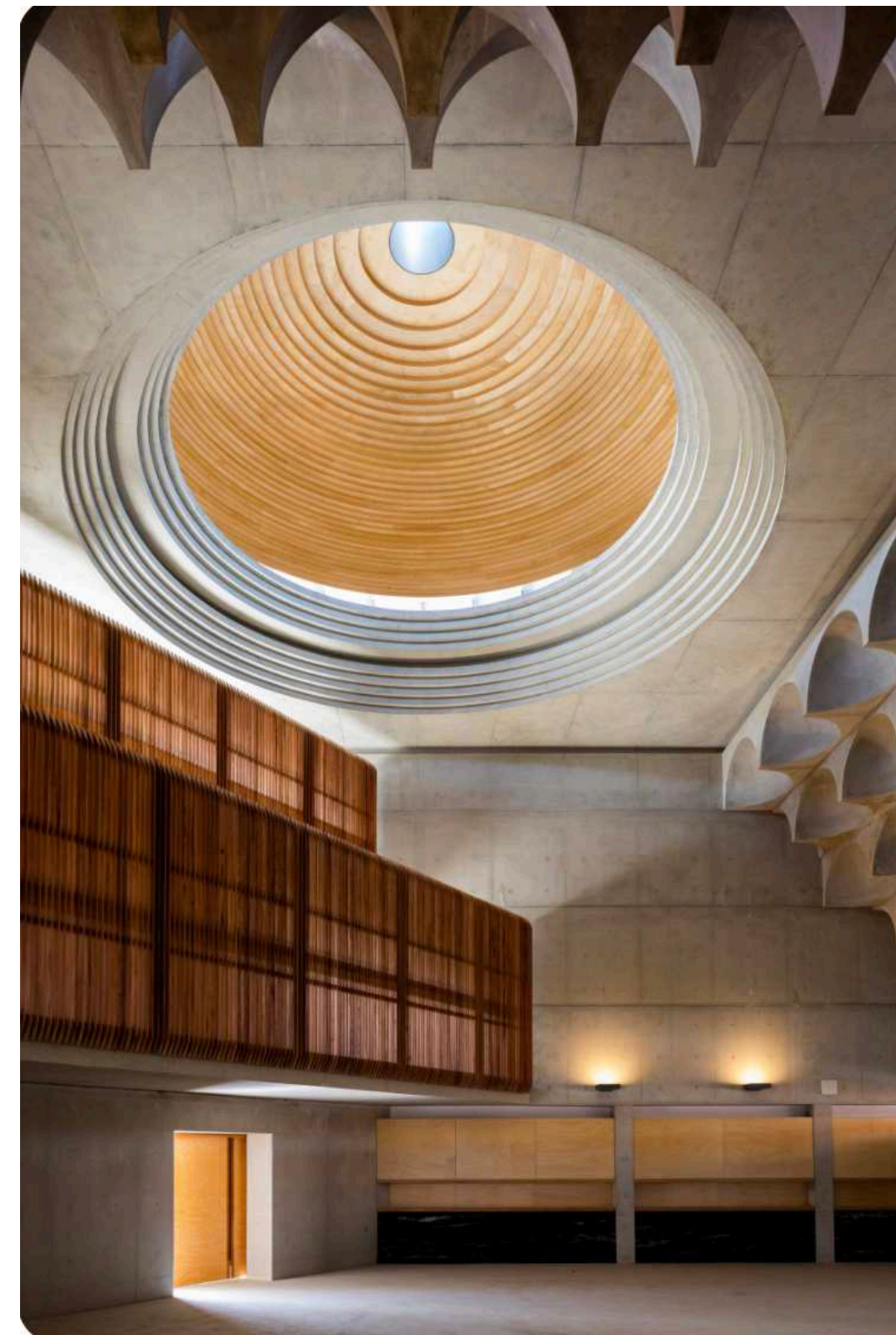

In terms of building this structure, it is organic and will challenge the local craftspeople. You will need to consider what materials are locally available. There's bamboo, timber, earth, bricks, concrete and any others you can think of.

construction methods



In terms of building this structure, it is organic and will challenge the local craftspeople. You will need to consider what materials are locally available. There's bamboo, timber, earth, bricks, concrete and any others you can think of.

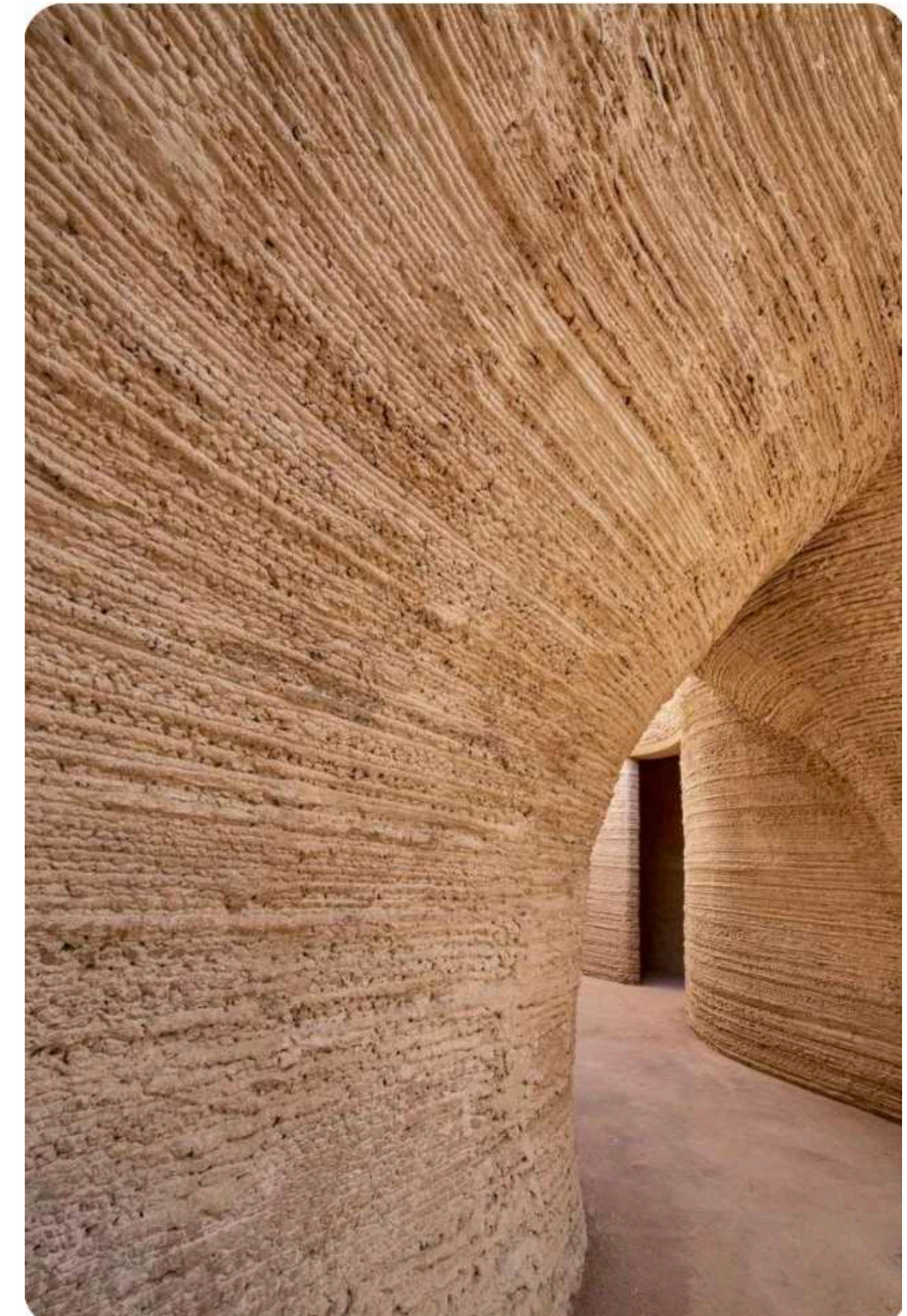

materials



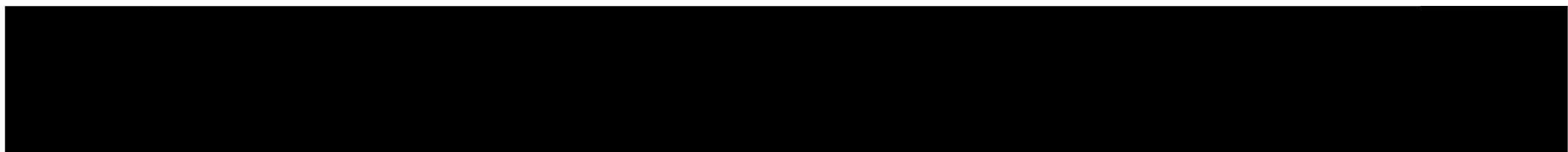
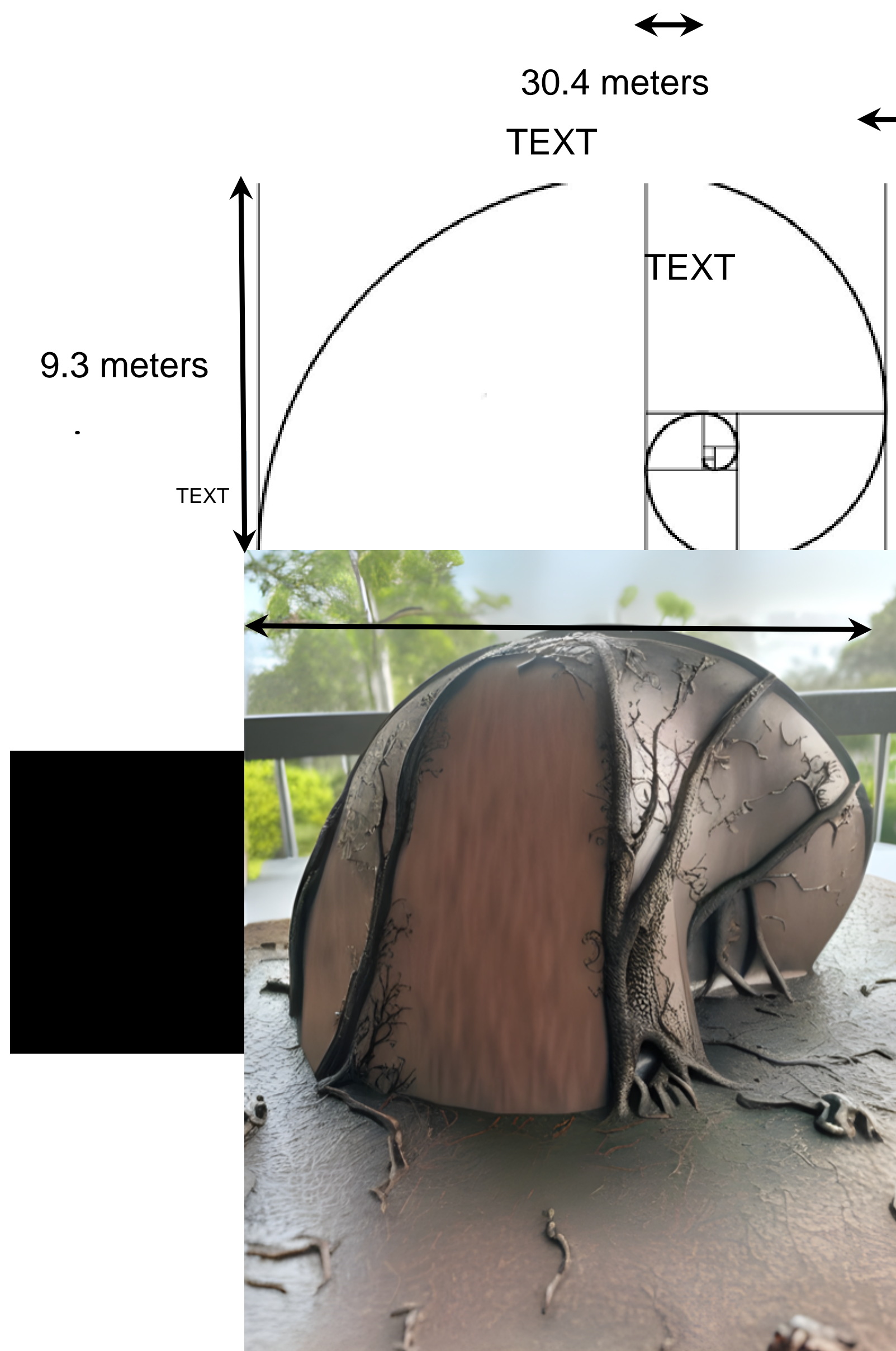

### Dimensions

9.3 meters high  
18.6 meters wide  
30.4meters length

TEXT

Length corrsponds to ancient temples and global architecture:

- Angor Wat (central temple)- Cambodia
- Temple of Kukulkan- Mexico
- Solomons Temple- Ancient Isreal
- Stonehenge- England
- Hekatompedon- Greece
- Ain Dara- Syria
- Parthenon (Cella) Greece
- Temple of Jupiter - Lebanon
- Cahokia Indian Mounds - United States
- The Obelisk of Theodosius - Egypt
- Temple of Karnak (oblisk) - Egypt

